

## Technical product information

---

### NOVALAB Optoelectronic Wall Mixer

**50 4000 00, 50 4000 00 01, 50 4001 00, 50 4001 00 01**

NOVALAB optoelectronic wall-mounted mixer DN 15 for connection to hot and cold water with integrated hygiene flushing for cyclical flushing of water pipes at risk of stagnation.

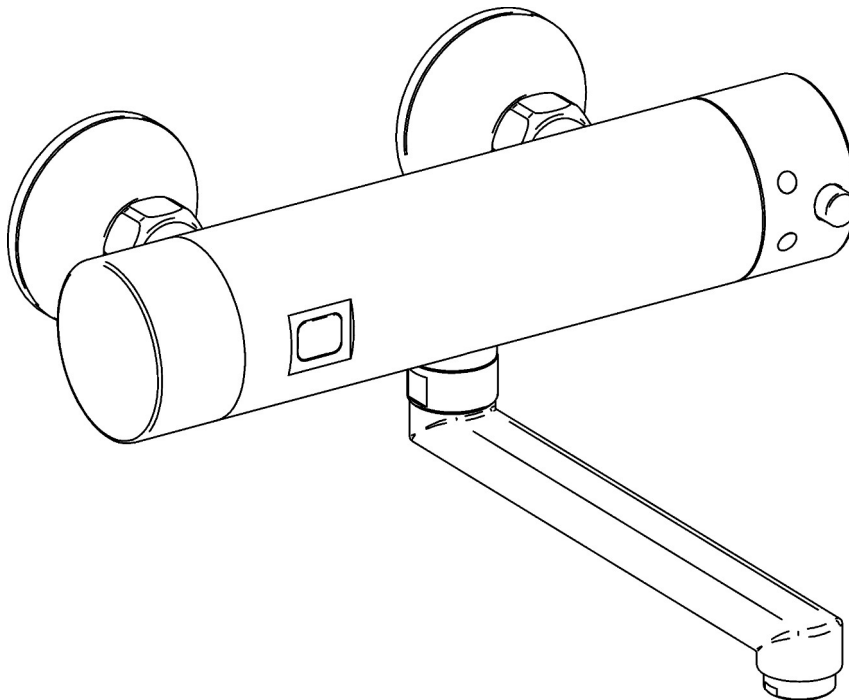

---

## Inhalt/Table of content

---

1.	Scope of delivery.....	3
2.	Measurements.....	4
3.	Explanation of symbols.....	6
4.	Warranty.....	6
5.	Important notes.....	6
6.	Application.....	7
7.	Technical data.....	7
8.	Mounting.....	8
9.	Function.....	11
10.	Maintenance and Care.....	13
11.	Troubleshooting.....	20
12.	Spare parts.....	21
	Contact.....	24

# 1. Scope of delivery

**50 4000 00**

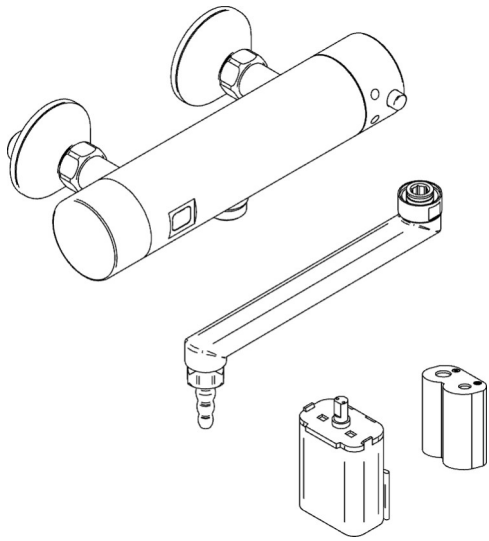

**50 4000 00 01**

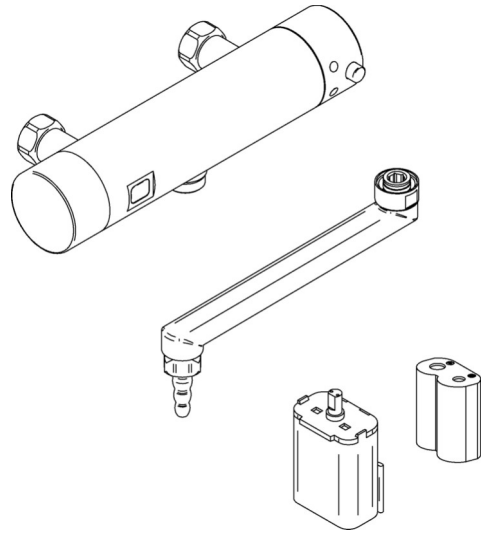

**50 4001 00**

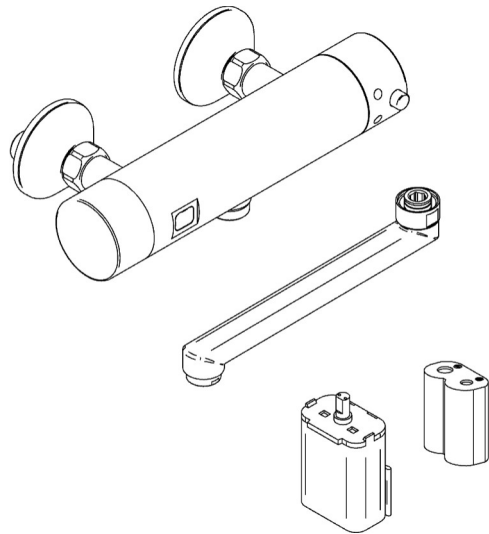

**50 4001 00 01**

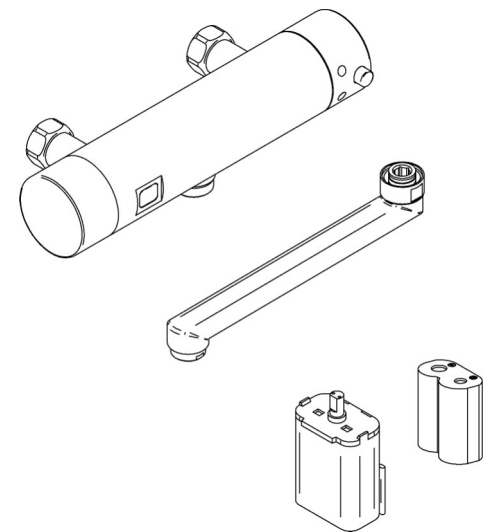

## 2. Measurements

### 50 4000 00

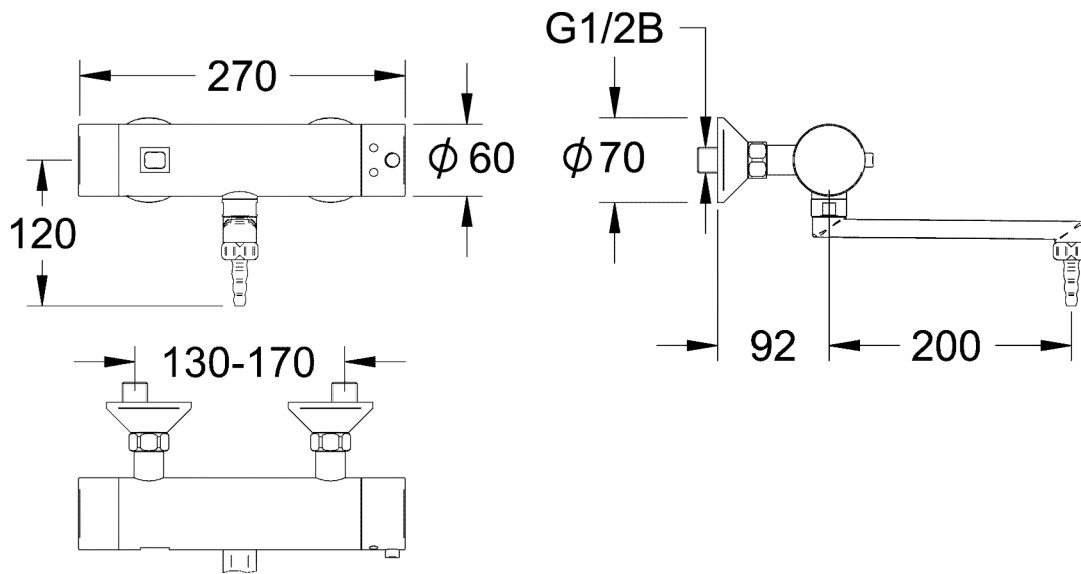

### 50 4000 00 01

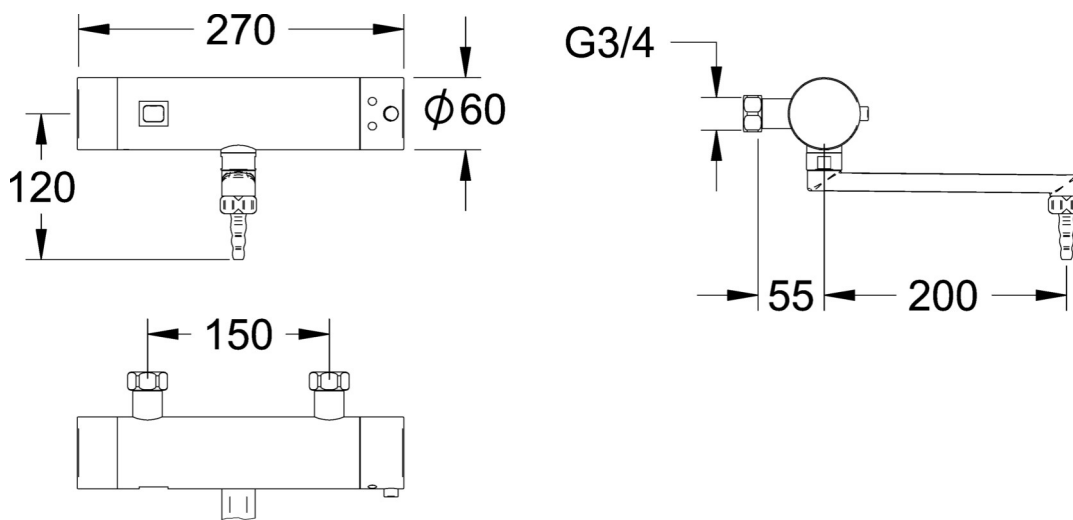

**50 4001 00**

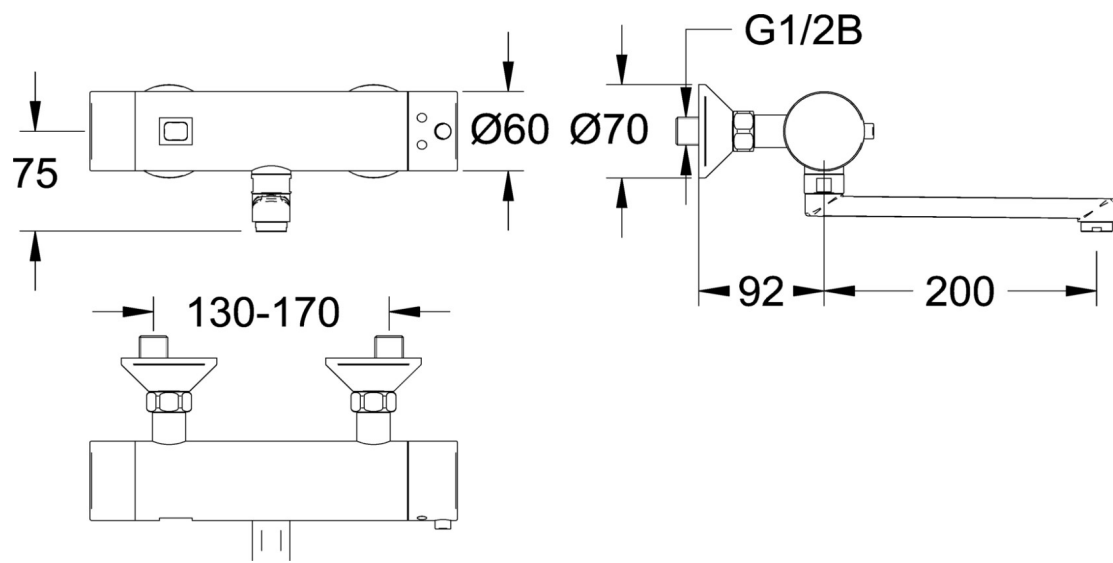

**50 4001 00 01**

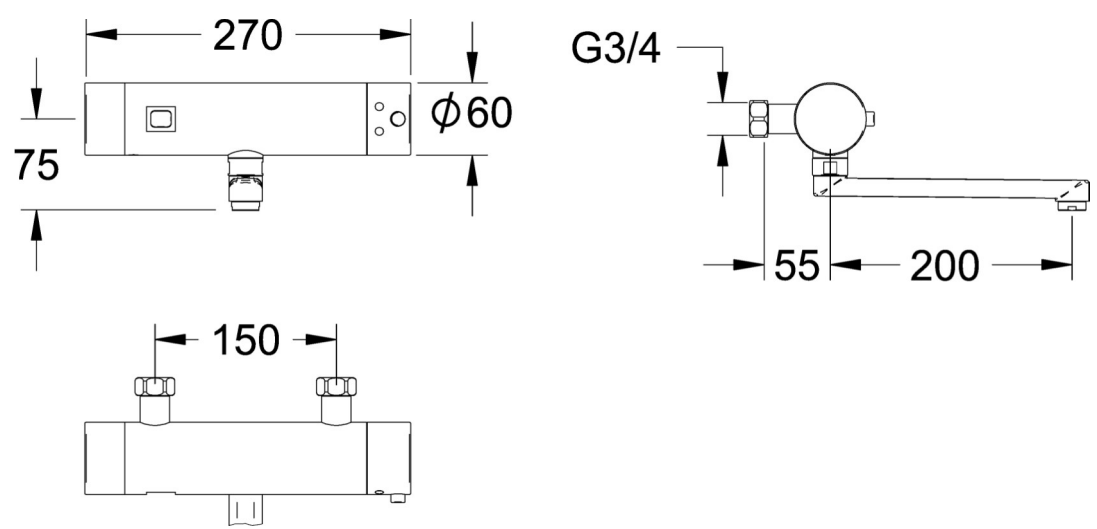

---

### 3. Explanation of symbols

---

 **Warning!**

Non-observance can cause danger to life or injury.

 **Warning!**

Non-observance can cause material damage.

 **Important!**

Non-observance may cause malfunctions.

 **Useful information for handling the product**

---

### 4. Warranty

---

In the event of functional or material defects, we shall be liable within the scope of our General Terms and Conditions of Sale and Delivery. Further claims are excluded. In case of improper handling, improper installation, effects of frost, contamination as well as improper use, we reject any warranty claim. Only use original NOVALAB spare parts!

---

### 5. Important notices

---

- Installation, commissioning and maintenance only by a specialist in accordance with these instructions.
- Legal regulations as well as the technical connection conditions of the local water supply companies must be observed.
- Before installation, the lines must be flushed according to DIN EN 806-4.
- Suitable cleaning agents that do not attack the fitting must be used properly and removed after use.
- Subject to changes and errors.

---

## 6. Application

---

Optoelectronic fitting for contactless dispensing of water with integrated hygiene flushing for cyclical flushing of water pipes at risk of stagnation.

---

## 7. Technical data

---

Minimum dynamic pressure:	1,0 bar
Maximum static pressure:	8 bar
Recommended dynamic pressure:	1-5 bar
Maximum operating temperature	
- Continuous operation:	70 °C
- Briefly (<10 min):	80 °C
Connection thread:	
50 04000 00, 5040010 00	G 1/2B
50 04000 00 01, 5040010 00 01	G 3/4
Flow rate:	11 l/min at 3 bar dynamic pressure
Protection class:	IP 56
Voltage details:	6 V using lithium battery CRP2
Power consumption:	max. 1,5 W

## 8. Mounting

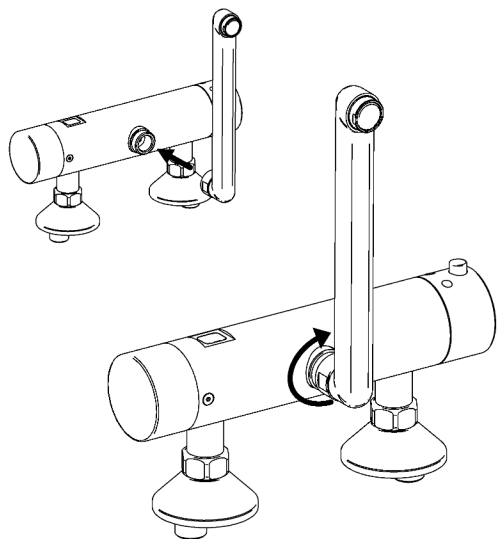

8.1 Screw on the spout.

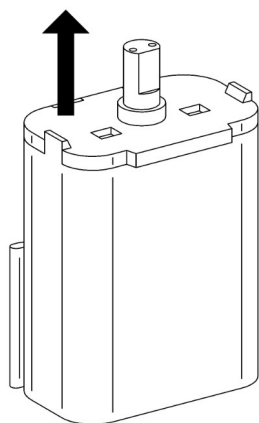

8.2 Pull the cover upwards off the battery box

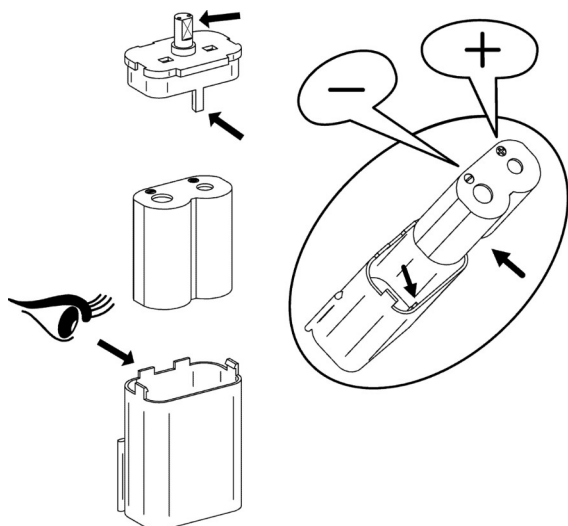

8.3 Insert battery.

➔ Pay attention to the installation position of the components!

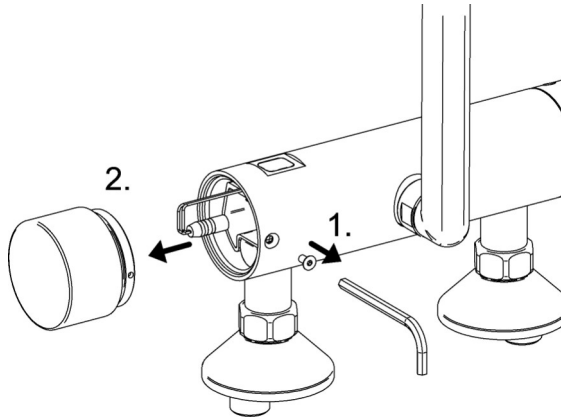

- 8.4** Remove the screw (1.) with an Allen key SW 2.5. Pull off the cap (2.).

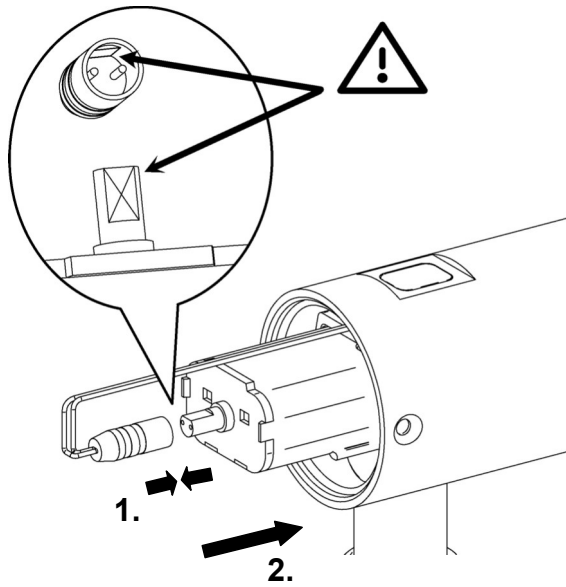

- 8.5** Connect battery box

- ▶ When commissioning, make sure that the detection range of the sensor is not covered.

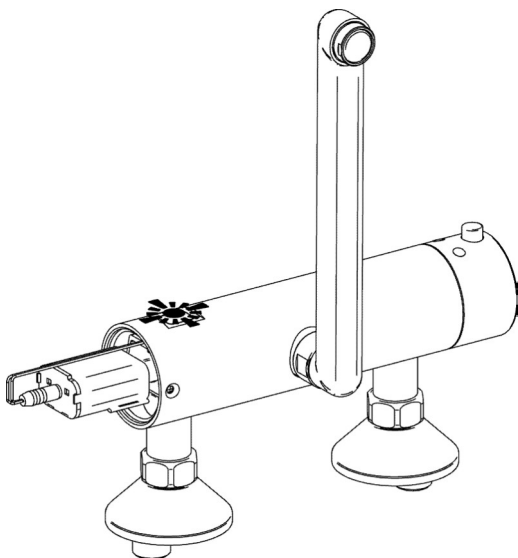

- 8.6** The fitting acknowledges the connection to the power supply with a short, rapid blinking several times (4x).

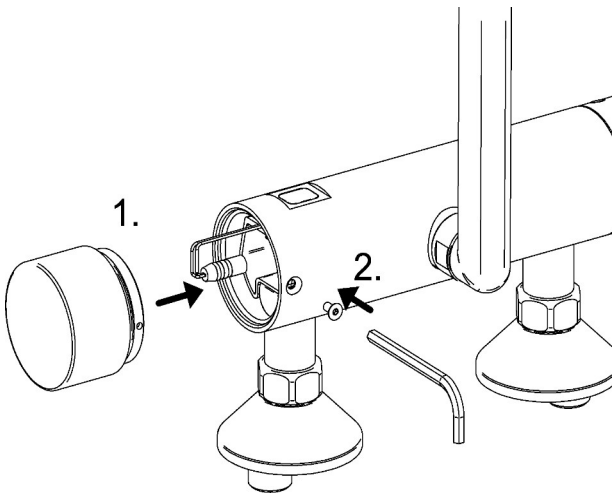

**8.7** Put on cap (1.)  
and secure with screw (2.).

➔ Use Allen key SW 2.5.

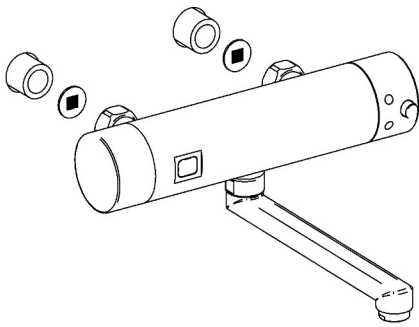

**8.8** Mount the wall mixer on the according  
water connections.  
Use an open-end spanner SW 30  
for this purpose

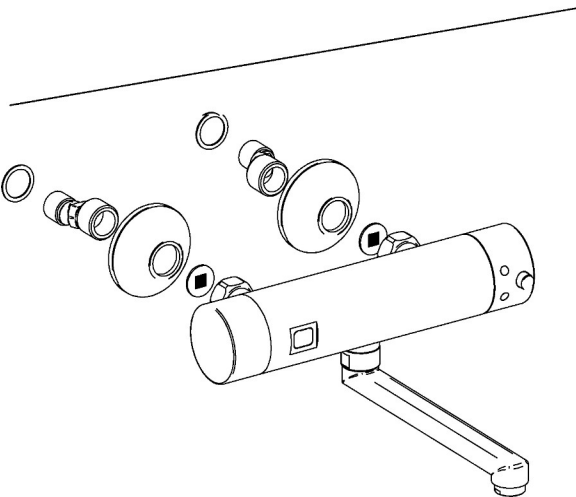

**8.9** Open the water supply.

▶ Check the function of the fitting.  
See next chapter.

▶ Check for leaks.

---

## 9. Function

---

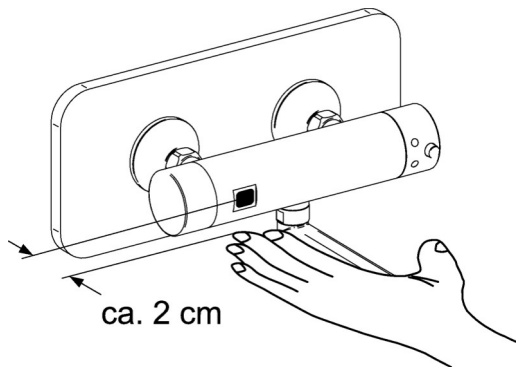

- 9.1** Bring the hands into the detection range of the sensor. Water run is started.

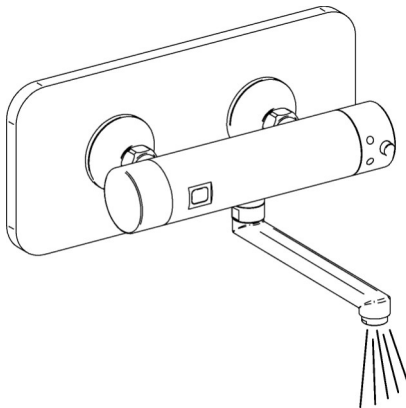

- 9.2** The fitting switches to body reflection.

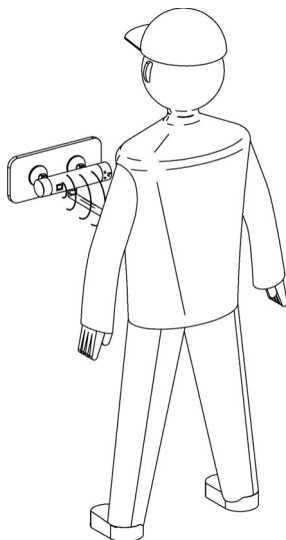

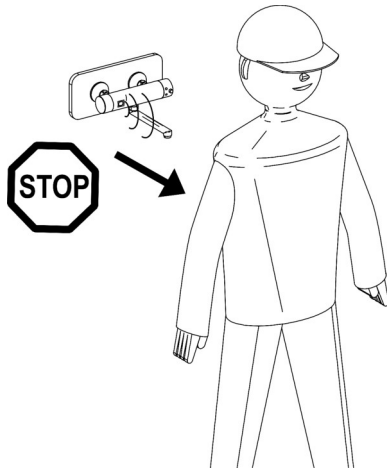

**9.3** Water flow stops when the user moves away from the tap.

**9.4** Water flow stops after 4 minutes, If water should continue to flow, trigger the tap again by hand.

➤ Water can also be stopped by triggering the sensor again by hand (close distance).

**9.5** Hygienic flushing of the tap 24 hours after the last use.

➤ Reprogramming the hygienic flushing with optional remote control. (See under item "Accessories").

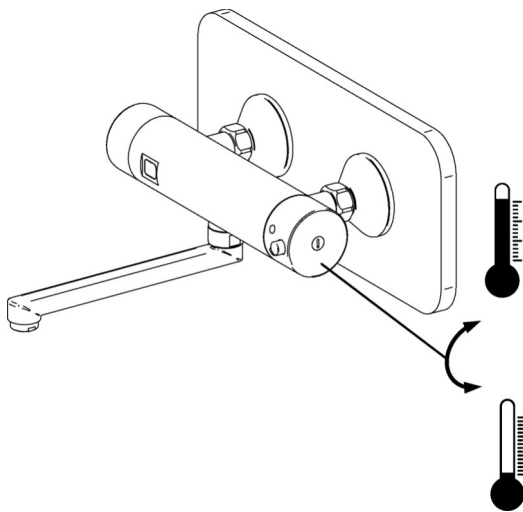

Mixing device

**9.6** Temperature selection by adjusting the mixing cap.

➤ If the mixing lever is in horizontal position, a mixing temperature of approx. 37 °C is set.

---

## 10. Maintenance and Care

---

Use suitable cleaning agents that do not attack the fitting and rinse with water after use. High-pressure cleaners must not be used for cleaning.

### Change aerator

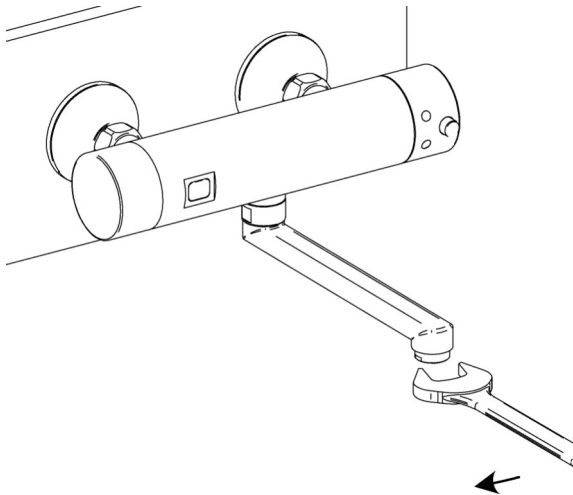

- 10.1** Cut off the water supply.
- 10.2** Unscrew the aerator with an open-end spanner SW 22.
  - Check aerator, clean and replace if necessary.
- 10.3** Establish the water supply.
  - ▶ Check the function!

## Change dirt trap strainers

### Examine the check valve and replace if necessary

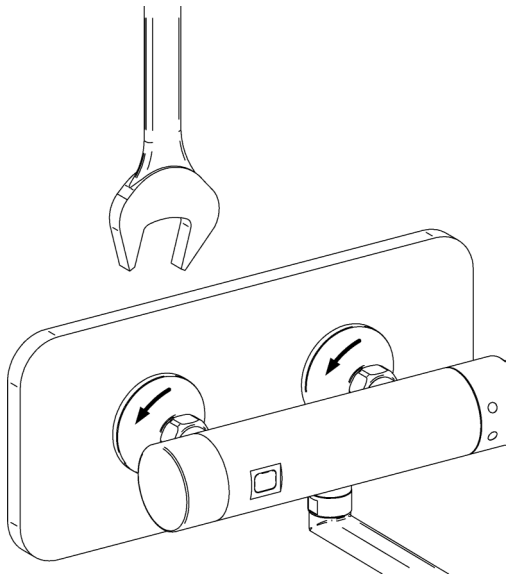

**10.4** Interrupt water supply

**10.5** Unscrew the fitting with an open-end spanner SW 30

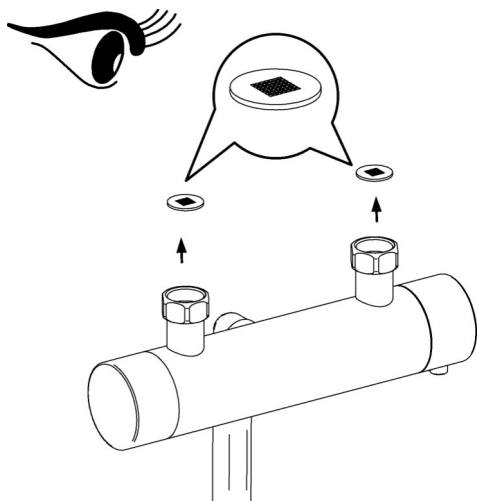

**10.6** Remove the strainer seals, check, clean and replace if necessary.

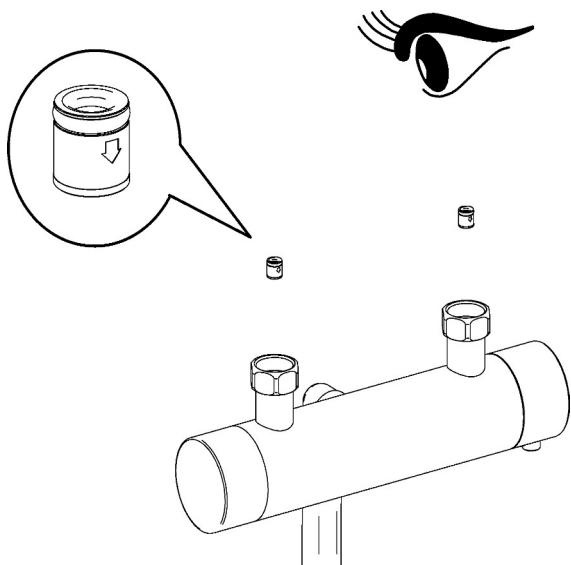

**10.7** Pull out the check valve.

**10.8** Examine the check valve.

➤ Use a blunt object, e.g. a ballpoint pen, to examine the check valve for ease of movement. If the closing mechanism does not move smoothly, replace the check valve.

**10.9** Insert the check valve.

**10.10** Reassemble in reverse order.

▶ Pay attention to the installation position of the components!

**10.11** Establish water supply.

▶ Check the function!

▶ Check for leaks!

## Change battery

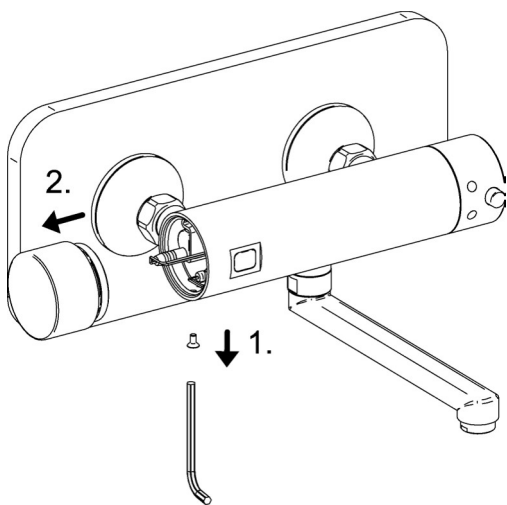

**10.12** Remove the screw (1.) with an Allen key SW 2.5. Pull off the cap (2.).

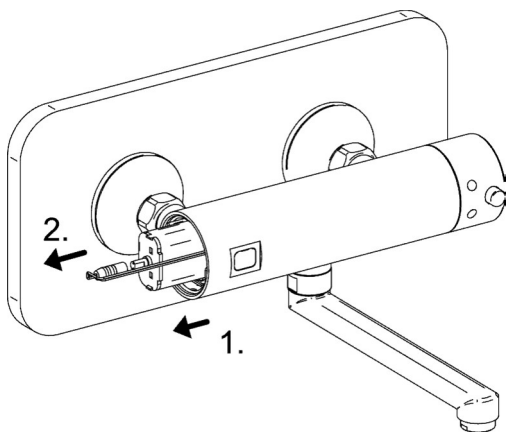

**10.13** Remove the battery compartment (1.). Remove the plug (2.) from the battery compartment.

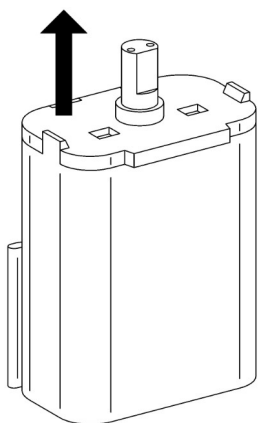

**10.14** Pull the lid upwards.

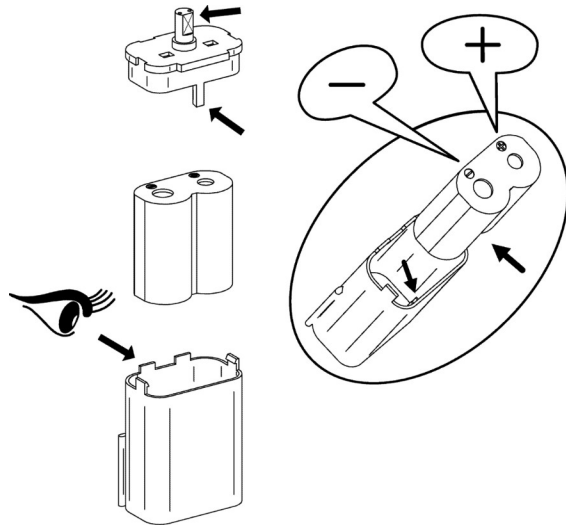

### 10.15 Install new battery.

- Pay attention to the installation position of the components!

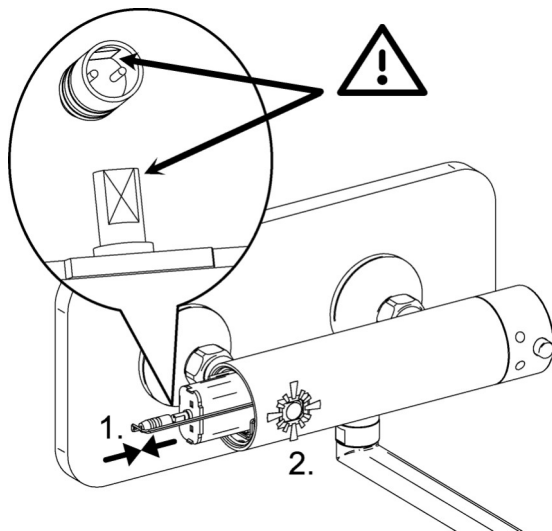

### 10.16 Reconnect the battery compartment.

- ▶ Pay attention to the coding on the connector!
- ▶ Connecting it the wrong way round can damage the electronics or the connector!
- ▶ Check the function of the fitting!
- The fitting acknowledges the connection to the power supply with a brief rapidly and repeatedly flashing (4x).

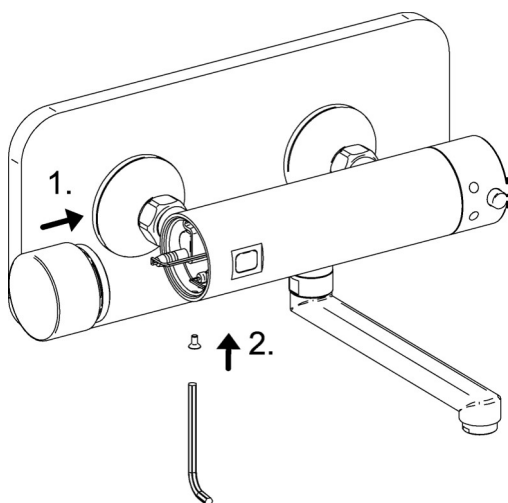

### 10.17 Put on cap (1.) and secure with screw (2.).

- Use Allen key SW 2.5.

## Change cartridge valve (solenoid valve)

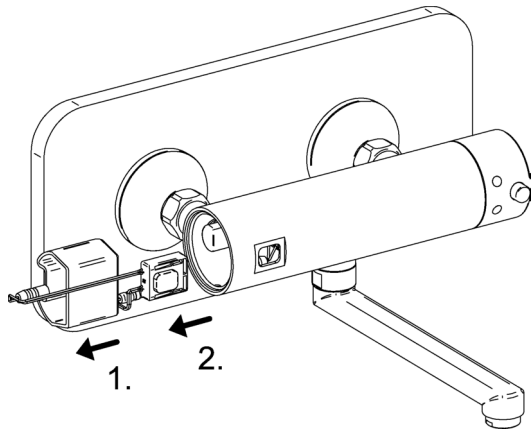

**10.18** Cut off the water supply.

**10.19** Carry out steps 10.13 and 10.14.

**10.20** Pull out the plastic clip (1.) and sensor unit (2.) and disconnect the plug connection to the solenoid valve..

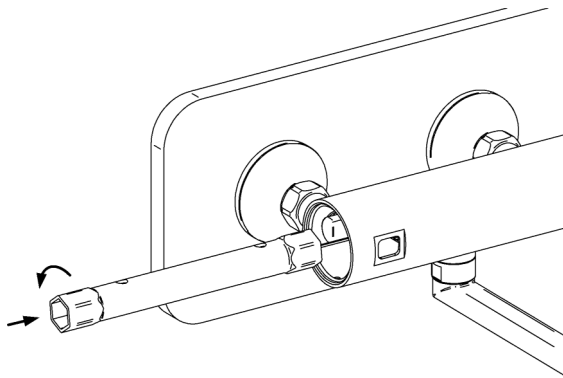

**10.21** Unscrew the cartridge valve with the SW 21 pipe spanner.

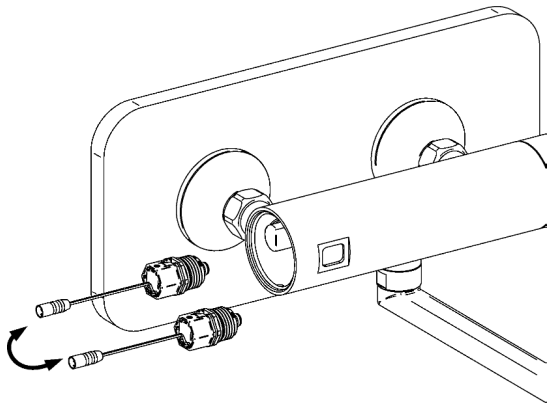

**10.22** Change the cartridge valve.

**▶ Tighten the cartridge valve with SW21 and 1 Nm!**

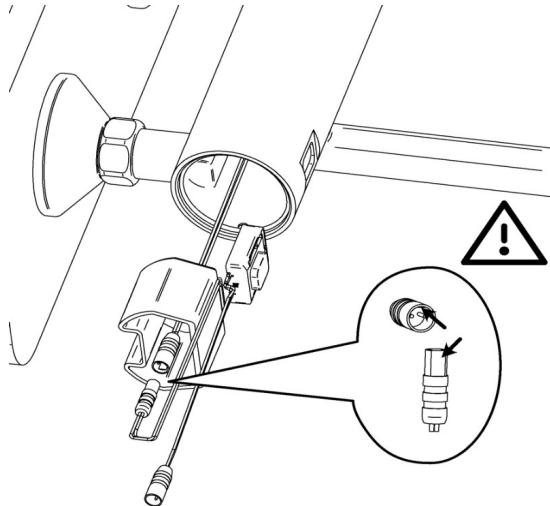

**10.23** Connect cartridge valve with sensor unit

▶ Pay attention to the coding on the connector!

▶ Connecting it the wrong way round can damage the electronics or the connector!

**10.24** Insert the sensor unit.

**10.25** Fix the sensor unit with the plastic clip.

**10.26** Further assembly See 10.16 and 10.17.

## 11. Troubleshooting

<b>Malfunction</b>	<b>Cause</b>	<b>Remedy</b>
Water volume too low	<ul style="list-style-type: none"> <li>• Defective check valve</li> <li>• Strainer / strainers dirty</li> <li>• Water pressure too low</li> <li>• Dirty solenoid valve</li> <li>• Aerator dirty / scaled</li> </ul>	<ul style="list-style-type: none"> <li>▶ Replace</li> <li>▶ Clean / Replace</li> <li>▶ Examine</li> <li>▶ Replace</li> <li>▶ Clean / Replace</li> </ul>
No water flows	<ul style="list-style-type: none"> <li>• Water supply interrupted</li> <li>• Solenoid valve dirty or defective</li> <li>• Strainer / strainers dirty</li> <li>• Battery low</li> </ul>	<ul style="list-style-type: none"> <li>▶ Restore</li> <li>▶ Replace</li> <li>▶ Clean / Replace</li> <li>▶ Replace battery</li> </ul>
Water flow stops	<ul style="list-style-type: none"> <li>• Maximum running time exceeded</li> </ul>	<ul style="list-style-type: none"> <li>▶ Restart fitting</li> </ul>
Fitting blinks slowly (once every 10s)	<ul style="list-style-type: none"> <li>• Battery low</li> </ul>	<ul style="list-style-type: none"> <li>▶ Replace battery</li> </ul>
<u>After battery change</u>	<ul style="list-style-type: none"> <li>• Battery inserted the wrong way round</li> </ul>	<ul style="list-style-type: none"> <li>▶ Insert battery according to illustration</li> </ul>
Water does not flow and tap does not blink	<ul style="list-style-type: none"> <li>• Plug connection not plugged in according to the coding</li> </ul>	<ul style="list-style-type: none"> <li>▶ Check plug connection, correct if necessary</li> </ul>

If a malfunction cannot be remedied or is not listed in the above table, please notify our customer service (see Contact).

## 12. Spare parts

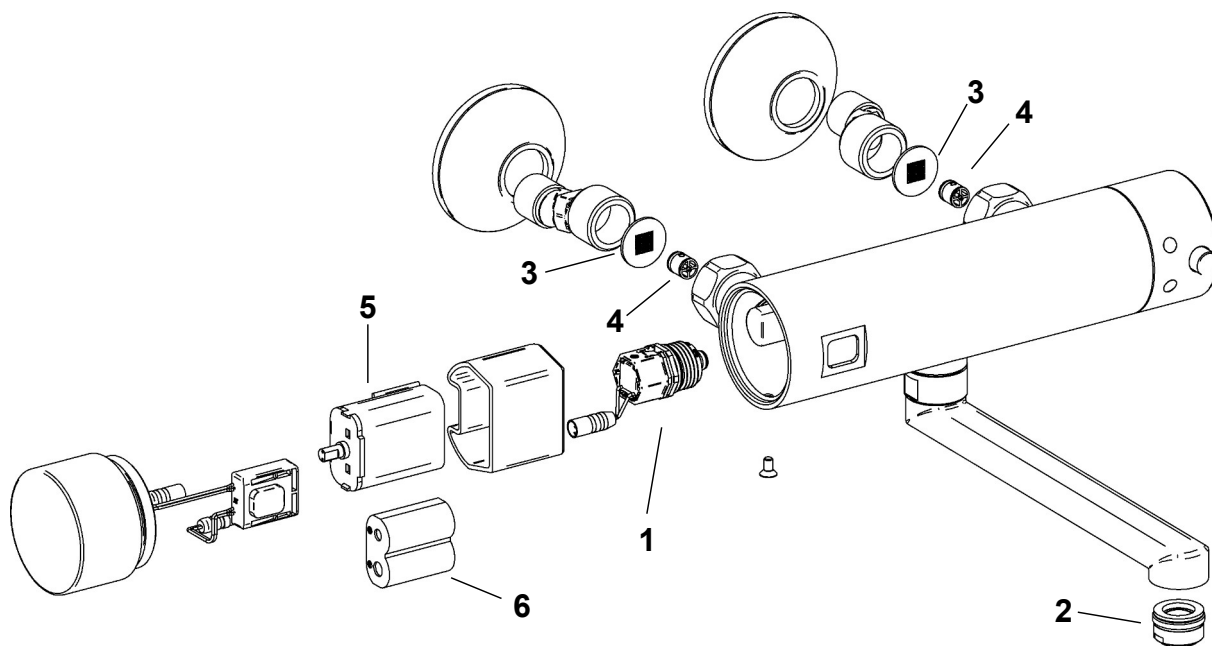

Spare parts		
	Description	Art.-Nr.
1	Solenoid valve	87 470 00 008
2	Aerator	87 230 00 007
3	Strainer / seal PU of 2 pieces	87 230 00 006
4	Check valve PU of 2 pieces	87 190 00 016
5	Battery compartment	87 470 00 003
6	6V lithium battery	87 470 00 004

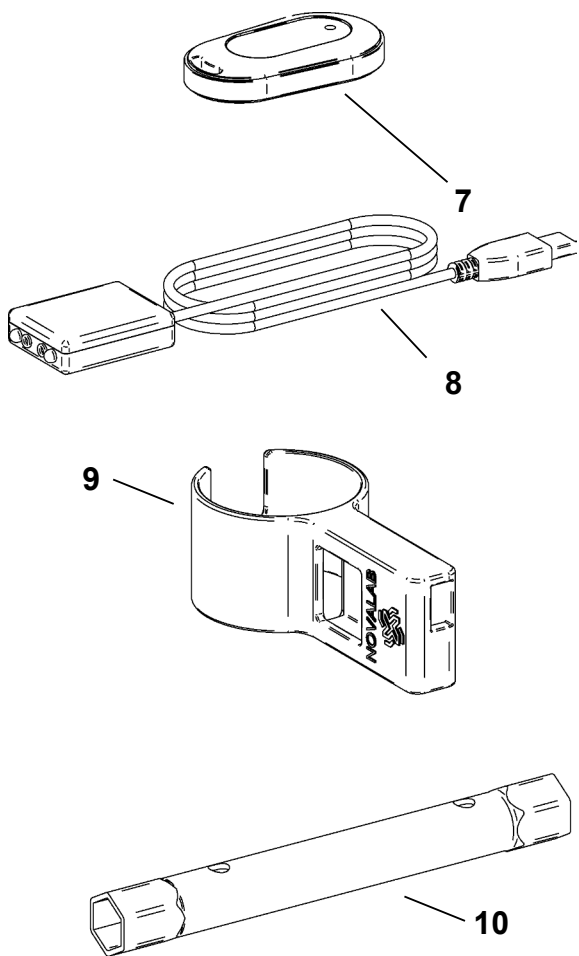

## Spare parts

Description	Art.-Nr.
<b>7</b> Remote control for switching on/off the hygiene flushing	51 0300 11
Remote control to activate/deactivate body reflection	51 0300 10
<b>8</b> Programming and readout module	51 0200 10
<b>9</b> Bracket for programming and readout module	51 0250 11
<b>10</b> Special key for cartridge valve	87 220 00 147
Software f. Programming and readout	51 0100 20

---

## Notes

---

---

## **Contact**

---

### **NOVALAB GmbH**

Brunsbütteler Damm 440

13591 Berlin

Phone: +49 (0) 30 36 403 36 11

Fax: +49 (0) 30 36 403 36 28

E-mail: [info@novalab-gmbh.de](mailto:info@novalab-gmbh.de)